



# Sierra Components, Inc.

2222 Park Place Building 3 Suite E • Minden, Nevada 89423

Phone: 775.783.4940 Fax: 775.783.4947

Chip back potential is the level which bulk silicon is maintained by on-chip connection, or it is the level to which the chip back must be connected when specifically stated below. If no potential is given the chip back should be isolated.

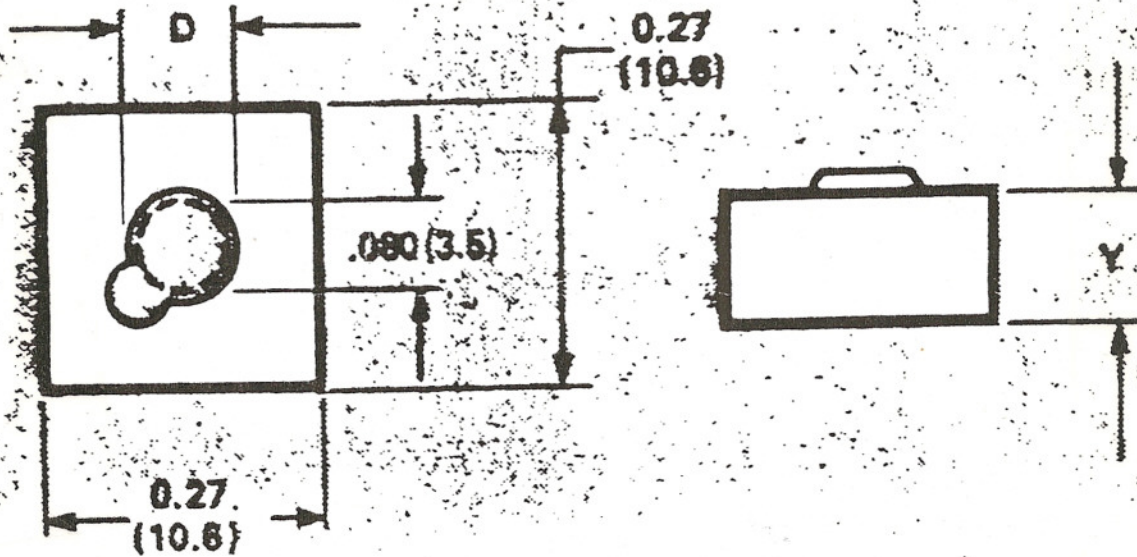

**OFFSET JUNCTION**

**Topside Metal: Al**

**Backside: Si**

**Backside Potential:**

**Mask Ref:**

**Bond Pads : .004 min**

**APPROVED BY: CB**

**MFG: Hewlett**

**DIE SIZE: .010" x .010"**

**THICKNESS: .019"**

**DATE: 2/6/01**

**P/N: HSMS-0003**